



Manual HEUSSER-Inset Locks



■ Manual Content

Dear customer, thank you for purchasing this tested Swiss quality product, which was developed and produced in Switzerland. These instructions are a part of the product. They are intended for both the installing technician and the user of HEUSSER-Inset Locks. Please familiarise yourself with all available information and recommendations before installing or using your product.

The product may only be installed and used in accordance with the areas of application specified in these instructions.

Please ensure that these instructions are provided to the contractor when the property is handed over.



■ Mutual screwing of the HEUSSER-Inset Locks

HEUSSER-Inset Locks / Plates are installed on both sides of the door and screwed together whenever possible. This ensures that emergency doors are properly and securely fastened.

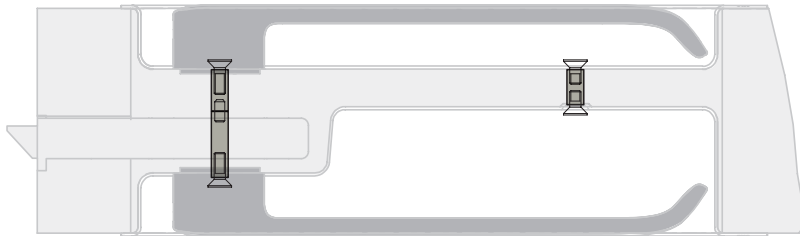

Diagram: Example installation of HEUSSER-Inset Lock

■ Assembly Instructions

Installation of the HEUSSER-Inset Locks

1. Prepare fasteners (from p. 8)





Screws:

Standard screws
for mutual screw
connection

M4x6  
 M4x8
 M4x10
 M4x12
 M4x14
 M4x16
 M4x18
 M4x20



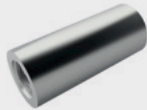

Screw for optics and
burglary protection:

M4x5B  



Threaded sleeves:



Threaded sleeves
for threaded sleeve
connection

H7  
 (M4Ø6x7)
 H14  
 (M4Ø6x14)
 H22  
 (M4Ø6x22)



Threaded pin:



Threaded pin for
threaded sleeve
connection

ST8  
 (M4x8)



Blind nut:

Blind nut for small door
thicknesses

BM4  
 (M4)



Loctite 270:

2. Connect the fasteners with the Inset Lock on the outside of the door

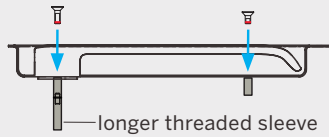

Exterior of the door

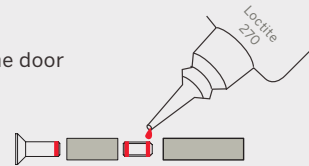

3. Pre-assemble the Inset Lock for the outside of the door

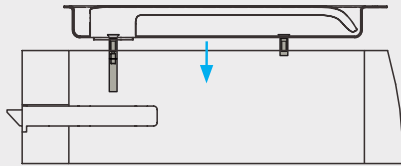

Exterior of the door

Interior of the door

4. Push the Inset Lock for the inside of the door into the pocket and screw it

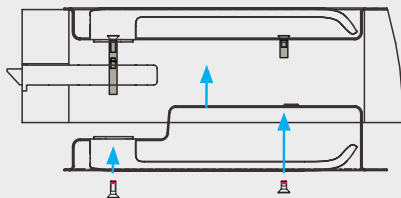

Exterior of the door

Interior of the door

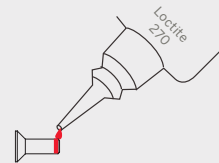

■ Combinations of the HEUSSER-Inset Locks

S9.42 in combination with:

HEUSSER-Inset Locks	from door thickness of	page
S1.0 (S1G.0)	43 mm	08 - 09
Sx.13	59 mm	10
Sx.20	66 mm	11
S9.42	88 mm	12
S6.42	88 mm	13

S6.42 in combination with:

HEUSSER-Inset Locks	from door thickness of	page
S1.0	56 mm	14
Sx.13	73 mm	15
Sx.20	80 mm	16
S6.42	102 mm	17

Sx.20 in combination with:

HEUSSER-Inset Locks	from door thickness of	page
S1.0	34 mm	18
Sx.13	51 mm	19
Sx.20	58 mm	20
S6.42	80 mm	16

■ Combinations of the HEUSSER-Inset Locks

Sx.13 in combination with:

HEUSSER-Inset Locks	from door thickness of	page
S1.0	27 mm	21
Sx.13	44 mm	22
Sx.20	51 mm	19
S6.42	73 mm	15

S1.0 in combination with:

HEUSSER-Inset Locks	from door thickness of	page
S1G.0	27 mm	23

S1G.0 in combination with:

HEUSSER-Inset Locks	from door thickness of	page
S1G.0	27 mm	24

Sx.13: All Inset Locks of the different series with the depth of 13 mm

Sx.20: All Inset Locks of the different series with the depth of 20 mm

■ S9.42 + S1G.0



S9.42.D3/4



S1G.0.D1/2/3/4 (G = perforated)

Existing values			Required installation hardware			
Door thickness:	Distance V:	Distance H:	Screw:	Threaded sleeve:	Threaded pin:	Blind nut:
43-45	26-28	4-6	3x M4x6	1x H22	1x ST8	3x BM4
45-47	28-30	6-8	3x M4x8	1x H22	1x ST8	3x BM4
47-49	30-32	8-10	3x M4x10	1x H22	1x ST8	3x BM4
49-51	32-34	10-12	3x M4x12	1x H22	1x ST8	3x BM4

All dimensions are in millimetres.

Distance V = Distance front / Distance = Distance rear

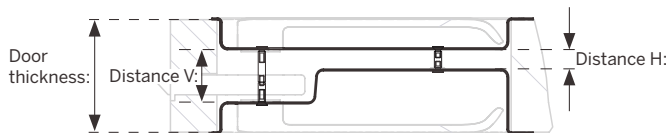

Diagram: Depiction of Distance V (front) and Distance H (rear) distance

■ S9.42 + S1.0



S9.42.D3/4



S1.0.D1/2/3/4

Existing values			Required installation hardware		
Door thickness:	Distance V:	Distance H:	Screw:	Threaded sleeve:	Threaded pin:
51-52	31-32	9-10	3x M4x6	1x H22	1x ST8
52-54	32-34	10-12	3x M4x8	1x H22	1x ST8
54-56	34-36	12-14	3x M4x10	1x H22	1x ST8
56-58	36-38	14-16	3x M4x12	1x H22	1x ST8
58-60	38-40	16-18	3x M4x14	1x H22	1x ST8
60-62	40-42	18-20	3x M4x16	1x H22	1x ST8
62-64	42-44	20-22	3x M4x18	1x H22	1x ST8
64-66	44-46	22-24	3x M4x20	1x H22	1x ST8
66-72	46-52	24-30	3x M4x12	1x H22 3x H14**	4x ST8
72-78	52-58	30-36	3x M4x18	1x H22 3x H14**	4x ST8
78-87	58-67	36-45	3x M4x20	4x H22	4x ST8
87-101	67-81	45-59	3x M4x20	4x H22 3x H14**	7x ST8

All dimensions are in millimetres.

Distance V = Distance front / Distance = Distance rear (see p. 8)

** When using different threaded sleeves, the longer threaded sleeve must be installed at the end (see p. 5)

■ S9.42 + Sx.13



S9.42.D3/4



S9.13.D3/4 - S6.13.D1/2 - S3.13.D1/2

Door thickness:	Existing values		Required installation hardware						
	Distance V:	Distance H:	Screw:			Threaded sleeve:		Threaded pin:	Blind nut:
59-61	26-28	4-6	3x M4x6			1x H22		1x ST8	3x BM4
61-63	28-30	6-8	3x M4x8			1x H22		1x ST8	3x BM4
63-65	30-32	8-10	3x M4x10			1x H22		1x ST8	3x BM4
65-67	32-34	10-12	3x M4x12			1x H22		1x ST8	3x BM4
67-68	34-35	12-13	3x M4x6*	2x M4x6	1x M4x16	2x H7	1x H22	-	-
68-70	35-37	13-15	3x M4x6*	2x M4x8	1x M4x16	2x H7	1x H22	-	-
70-72	37-39	15-17	3x M4x6*	2x M4x10	1x M4x16	2x H7	1x H22	-	-
72-74	39-41	17-19	3x M4x6*	2x M4x12	1x M4x16	2x H7	1x H22	-	-
74-80	41-47	19-25	3x M4x6*	3x M4x12		3x H14**	1x H22**	1x ST8	-
80-84	47-51	25-29	3x M4x6*	3x M4x18		3x H14**	1x H22**	1x ST8	-
84-98	51-65	29-43	3x M4x6*	3x M4x20		4x H22		1x ST8	-

All dimensions are in millimetres.

Distance V = Distance front / Distance = Distance rear (see p. 8)

Sx.13: All Inset Locks of the different series with the depth of 13 mm

* Alternative to M4x6: Blind screw M4x5B (optics / burglary protection) on the outside of the door

** When using different threaded sleeves, the longer threaded sleeve must be installed at the end (see p. 5)

■ S9.42 + Sx.20



S9.42.D3/4



S9.20.D3/4 - S6.20.D1/2 - S3.20.D1/2

Door thickness:	Existing values		Required installation hardware					
	Distance V:	Distance V:	Screw:	Threaded sleeve:		Threaded pin:	Blind nut:	
66-68	26-28	4-6	3x M4x6	1x H22		1x ST8	3x BM4	
68-70	28-30	6-8	3x M4x8	1x H22		1x ST8	3x BM4	
70-72	30-32	8-10	3x M4x10	1x H22		1x ST8	3x BM4	
72-74	32-34	10-12	3x M4x12	1x H22		1x ST8	3x BM4	
74-75	34-35	12-13	3x M4x6* 2x M4x6 1x M4x16	2x H7	1x H22	-	-	
75-77	35-37	13-15	3x M4x6* 2x M4x8 1x M4x16	2x H7	1x H22	-	-	
77-79	37-39	15-17	3x M4x6* 2x M4x10 1x M4x16	2x H7	1x H22	-	-	
79-81	39-41	17-19	3x M4x6* 2x M4x12 1x M4x16	2x H7	1x H22	-	-	
81-87	41-47	19-25	3x M4x6* 3x M4x12	3x H14**	1x H22**	1x ST8	-	
87-91	47-51	25-29	3x M4x6* 3x M4x18	3x H14**	1x H22**	1x ST8	-	
91-105	51-65	29-43	3x M4x6* 3x M4x20	4x H22		1x ST8	-	

All dimensions are in millimetres.

Distance V = Distance front / Distance = Distance rear (see p. 8)

Sx.20: All Inset Locks of the different series with the depth of 20 mm

* Alternative to M4x6: Blind screw M4x5B (optics / burglary protection) on the outside of the door

** When using different threaded sleeves, the longer threaded sleeve must be installed at the end (see p. 5)

■ S9.42 + S9.42



S9.42.D3/4



S9.42.D3/4

Door thickness:	Existing values		Required installation hardware						
	Distance V:	Distance H:	Screw:			Threaded sleeve:		Threaded pin:	Blind nut:
88-90	48-50	4-6	3x M4x6			2x H22		2x ST8	3x BM4
90-92	50-52	6-8	3x M4x8			2x H22		2x ST8	3x BM4
92-94	52-54	8-10	3x M4x10			2x H22		2x ST8	3x BM4
94-96	54-56	10-12	3x M4x12			2x H22		2x ST8	3x BM4
96-97	56-57	12-13	3x M4x6*	2x M4x6	1x M4x16	2x H7	2x H22	1x ST8	-
97-99	57-59	13-15	3x M4x6*	2x M4x8	1x M4x16	2x H7	2x H22	1x ST8	-
99-101	59-61	15-17	3x M4x6*	2x M4x10	1x M4x16	2x H7	2x H22	1x ST8	-
101-103	61-63	17-19	3x M4x6*	2x M4x12	1x M4x16	2x H7	2x H22	1x ST8	-
103-109	63-69	19-25	3x M4x6*	3x M4x12		3x H14**	2x H22**	2x ST8	-
109-113	69-73	25-29	3x M4x6*	3x M4x18		3x H14**	2x H22**	2x ST8	-
113-127	73-87	29-43	3x M4x6*	3x M4x20		5x H22		2x ST8	-

All dimensions are in millimetres.

Distance V = Distance front / Distance = Distance rear (see p. 8)

* Alternative to M4x6: Blind screw M4x5B (optics / burglary protection) on the outside of the door

** When using different threaded sleeves, the longer threaded sleeve must be installed at the end (see p. 5)

■ S9.42 + S6.42



S9.42.D3/4



S6.42.D2

Door thickness:	Existing values		Required installation hardware						
	Distance V:	Distance H:	Screw:			Threaded sleeve:		Threaded pin:	Blind nut:
88-90	26-28	4-6	3x M4x6			1x H22		2x ST8	3x BM4
90-92	28-30	6-8	3x M4x8			1x H22		2x ST8	3x BM4
92-94	30-32	8-10	3x M4x10			1x H22		2x ST8	3x BM4
94-96	32-34	10-12	3x M4x12			1x H22		2x ST8	3x BM4
96-97	34-35	12-13	3x M4x6*	2x M4x6	1x M4x16	2x H7	1x H22	1x ST8	-
97-99	35-37	13-15	3x M4x6*	2x M4x8	1x M4x16	2x H7	1x H22	1x ST8	-
99-101	37-39	15-17	3x M4x6*	2x M4x10	1x M4x16	2x H7	1x H22	1x ST8	-
101-103	39-41	17-19	3x M4x6*	2x M4x12	1x M4x16	2x H7	1x H22	1x ST8	-
103-109	41-47	19-25	3x M4x6*	3x M4x12		3x H14**	1x H22**	2x ST8	-
109-113	47-51	25-29	3x M4x6*	3x M4x18		3x H14**	1x H22**	2x ST8	-
113-127	51-65	29-43	3x M4x6*	3x M4x20		4x H22		2x ST8	-

All dimensions are in millimetres.

Distance V = Distance front / Distance = Distance rear (see p. 8)

* Alternative to M4x6: Blind screw M4x5B (optics / burglary protection) on the outside of the door

** When using different threaded sleeves, the longer threaded sleeve must be installed at the end (see p. 5)

■ S6.42 + S1.0



S6.42.D2



S1.0.D1/2/3/4

Existing values		Required installation hardware		
Door thickness:	Distance:	Screw:	Threaded sleeve:	Threaded pin:
56-58	14-16	3x M4x12	-	-
58-60	16-18	3x M4x14	-	-
60-62	18-20	3x M4x16	-	-
62-64	20-22	3x M4x18	-	-
64-66	22-24	3x M4x20	-	-
66-72	24-30	3x M4x12	3x H14	3x ST8
72-78	30-36	3x M4x18	3x H14	3x ST8
78-87	36-45	3x M4x20	3x H22	3x ST8
87-101	45-59	3x M4x20	3x H14** 1x H22**	6x ST8

All dimensions are in millimetres.

** When using different threaded sleeves, the longer threaded sleeve must be installed at the end (see p. 5)

■ S6.42 + Sx.13



S6.42.D2



S9.13.D3/4 - S6.13.D1/2 - S3.13.D1/2

Existing values		Required installation hardware			
Door thickness:	Distance:	Screw:		Threaded sleeve:	Threaded pin:
73-77	18-22	3x M4x6*	3x M4x12	3x H14	-
77-81	22-26	3x M4x6*	3x M4x16	3x H14	-
81-85	26-30	3x M4x6*	3x M4x20	3x H14	-
85-95	30-40	3x M4x6*	3x M4x20	3x H22	3x ST8
95-103	40-53	3x M4x6*	3x M4x20	3x H14** 3x H22**	3x ST8
103-111	53-61	3x M4x6*	3x M4x20	6x H22	3x ST8

All dimensions are in millimetres.

Sx.13: All Inset Locks of the different series with the depth of 13 mm

* Alternative to M4x6: Blind screw M4x5B (optics / burglary protection) on the outside of the door

** When using different threaded sleeves, the longer threaded sleeve must be installed at the end (see p. 5)

■ S6.42 + Sx.20



S6.42.D2



S9.20.D3/4 - S6.20.D1/2 - S3.20.D1/2

Existing values		Required installation hardware			
Door thickness:	Distance:	Screw:		Threaded sleeve:	Threaded pin:
80-84	18-22	3x M4x6*	3x M4x12	3x H14	-
84-88	22-26	3x M4x6*	3x M4x16	3x H14	-
88-92	26-30	3x M4x6*	3x M4x20	3x H14	-
92-102	30-40	3x M4x6*	3x M4x20	3x H22	3x ST8
102-115	40-53	3x M4x6*	3x M4x20	3x H14** 3x H22**	3x ST8
115-123	53-61	3x M4x6*	3x M4x20	6x H22	3x ST8

All dimensions are in millimetres.

Sx.20: All Inset Locks of the different series with the depth of 20 mm

* Alternative to M4x6: Blind screw M4x5B (optics / burglary protection) on the outside of the door

** When using different threaded sleeves, the longer threaded sleeve must be installed at the end (see p. 5)

■ S6.42 + S6.42



S6.42.D2



S6.42.D2

Existing values		Required installation hardware			
Door thickness:	Distance:	Screw:		Threaded sleeve:	Threaded pin:
102-106	18-22	3x M4x6*	3x M4x12	3x H14	-
106-110	22-26	3x M4x6*	3x M4x16	3x H14	-
110-114	26-30	3x M4x6*	3x M4x20	3x H14	-
114-124	30-40	3x M4x6*	3x M4x20	3x H22	3x ST8
124-137	40-53	3x M4x6*	3x M4x20	3x H14** 3x H22**	3x ST8
137-145	53-61	3x M4x6*	3x M4x20	6x H22	3x ST8

All dimensions are in millimetres.

* Alternative to M4x6: Blind screw M4x5B (optics / burglary protection) on the outside of the door

** When using different threaded sleeves, the longer threaded sleeve must be installed at the end (see p. 5)

■ Sx.20 + S1.0



S9.20.D3/4 - S6.20.D1/2 - S3.20.D1/2



S1.0.D1/2/3/4

Existing values		Required installation hardware		
Door thickness:	Distance:	Screw:	Threaded sleeve:	Threaded pin:
34-36	14-16	3x M4x12	-	-
36-38	16-18	3x M4x14	-	-
38-40	18-20	3x M4x16	-	-
40-42	20-22	3x M4x18	-	-
42-44	22-24	3x M4x20	-	-
44-50	24-30	3x M4x12	3x H14	3x ST8
50-56	30-36	3x M4x18	3x H14	3x ST8
56-65	36-45	3x M4x20	3x H22	3x ST8
65-79	45-59	3x M4x20	3x H14** 1x H22**	6x ST8

All dimensions are in millimetres.

Sx.20: All Inset Locks of the different series with the depth of 20 mm

** When using different threaded sleeves, the longer threaded sleeve must be installed at the end (see p. 5)

■ Sx.20 + Sx.13



S9.20.D3/4 - S6.20.D1/2 - S3.20.D1/2



S9.13.D3/4 - S6.13.D1/2 - S3.13.D1/2

Existing values		Required installation hardware			
Door thickness:	Distance:	Screw:		Threaded sleeve:	Threaded pin:
51-55	18-22	3x M4x6*	3x M4x12	3x H14	-
55-59	22-26	3x M4x6*	3x M4x16	3x H14	-
59-63	26-30	3x M4x6*	3x M4x20	3x H14	-
63-73	30-40	3x M4x6*	3x M4x20	3x H22	-
73-86	40-53	3x M4x6*	3x M4x20	3x H14** 3x H22**	3x ST8
86-94	53-61	3x M4x6*	3x M4x20	6x H22	3x ST8

All dimensions are in millimetres.

Sx.13: All Inset Locks of the different series with the depth of 13 mm

Sx.20: All Inset Locks of the different series with the depth of 20 mm

* Alternative to M4x6: Blind screw M4x5B (optics / burglary protection) on the outside of the door

** When using different threaded sleeves, the longer threaded sleeve must be installed at the end (see p. 5)

■ Sx.20 + Sx.20



S9.20.D3/4 - S6.20.D1/2 - S3.20.D1/2



S9.20.D3/4 - S6.20.D1/2 - S3.20.D1/2

Existing values		Required installation hardware			
Door thickness:	Distance:	Screw:		Threaded sleeve:	Threaded pin:
58-62	18-22	3x M4x6*	3x M4x12	3x H14	-
62-66	22-26	3x M4x6*	3x M4x16	3x H14	-
66-70	26-30	3x M4x6*	3x M4x20	3x H14	-
70-80	30-40	3x M4x6*	3x M4x20	3x H22	-
80-93	40-53	3x M4x6*	3x M4x20	3x H14** 3x H22**	3x ST8
93-101	53-61	3x M4x6*	3x M4x20	6x H22	3x ST8

All dimensions are in millimetres.

Sx.20: All Inset Locks of the different series with the depth of 20 mm

* Alternative to M4x6: Blind screw M4x5B (optics / burglary protection) on the outside of the door

** When using different threaded sleeves, the longer threaded sleeve must be installed at the end (see p. 5)

■ Sx.13 + S1.0



S9.13.D3/4 - S6.13.D1/2 - S3.13.D1/2



S1.0.D1/2/3/4

Existing values		Required installation hardware		
Door thickness:	Distance:	Screw:	Threaded sleeve:	Threaded pin:
27-29	14-16	3x M4x12	-	-
29-31	16-18	3x M4x14	-	-
31-33	18-20	3x M4x16	-	-
33-35	20-22	3x M4x18	-	-
35-37	22-24	3x M4x20	-	-
37-43	24-30	3x M4x12	3x H14	3x ST8
43-49	30-36	3x M4x18	3x H14	3x ST8
49-58	36-45	3x M4x20	3x H22	3x ST8
58-72	45-59	3x M4x20	3x H14** 3x H22**	6x ST8

All dimensions are in millimetres.

Sx.13: All Inset Locks of the different series with the depth of 13 mm

** When using different threaded sleeves, the longer threaded sleeve must be installed at the end (see p. 5)

■ Sx.13 + Sx.13



S9.13.D3/4 - S6.13.D1/2 - S3.13.D1/2



S9.13.D3/4 - S6.13.D1/2 - S3.13.D1/2

Existing values		Required installation hardware			
Door thickness:	Distance:	Screw:		Threaded sleeve:	Threaded pin:
44-48	18-22	3x M4x6*	3x M4x12	3x H14	-
48-52	22-26	3x M4x6*	3x M4x16	3x H14	-
52-56	26-30	3x M4x6*	3x M4x20	3x H14	-
56-66	30-40	3x M4x6*	3x M4x20	3x H22	-
66-79	40-53	3x M4x6*	3x M4x20	3x H14** 3x H22**	3x ST8
79-87	53-61	3x M4x6*	3x M4x20	6x H22	3x ST8

All dimensions are in millimetres.

Sx.13: All Inset Locks of the different series with the depth of 13 mm

* Alternative to M4x6: Blind screw M4x5B (optics / burglary protection) on the outside of the door

** When using different threaded sleeves, the longer threaded sleeve must be installed at the end (see p. 5)

■ S1.0 + S1G.0

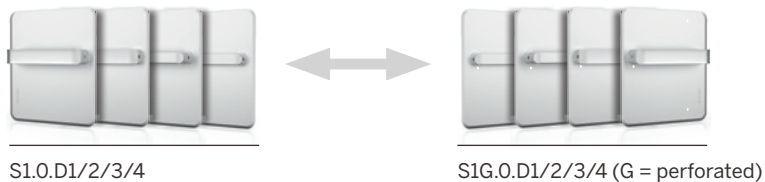

Existing values		Required installation hardware		
Door thickness:	Distance:	Screw:	Threaded sleeve:	Threaded pin:
27-32	27-32	3x M4x20	3x H14	3x ST8
32-42	32-42	3x M4x20	3x H22	3x ST8
42-54	42-54	3x M4x20	3x H14** 3x H22**	6x ST8
54-64	54-64	3x M4x20	6x H22	6x ST8
64-76	64-76	3x M4x20	3x H14** 6x H22**	9x ST8

All dimensions are in millimetres.

* Alternative to M4x6: Blind screw M4x5B (optics / burglary protection) on the outside of the door

** When using different threaded sleeves, the longer threaded sleeve must be installed at the end (see p. 5)

■ S1G.0 + S1G.0



S1G.0.D1/2/3/4 (G = perforated)



S1G.0.D1/2/3/4 (G = perforated)

Existing values		Required installation hardware			
Door thickness:	Distance:	Screw:		Threaded sleeve:	Threaded pin:
27-34	27-34	3x M4x6*	3x M4x20	3x H22	-
34-46	34-46	3x M4x6*	3x M4x20	3x H14** 3x H22**	3x ST8
46-56	46-56	3x M4x6*	3x M4x20	6x H22	3x ST8
56-68	56-68	3x M4x6*	3x M4x20	3x H14** 6x H22**	6x ST8
68-78	68-78	3x M4x6*	3x M4x20	9x H22	9x ST8

All dimensions are in millimetres.

* Alternative to M4x6: Blind screw M4x5B (optics / burglary protection) on the outside of the door

** When using different threaded sleeves, the longer threaded sleeve must be installed at the end (see p. 5)



■ Drilling pattern pointing to the right
HEUSSER-Inset Locks

Drilling pattern 1:1
Right pointing handle

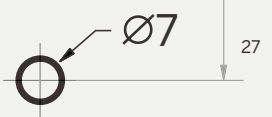
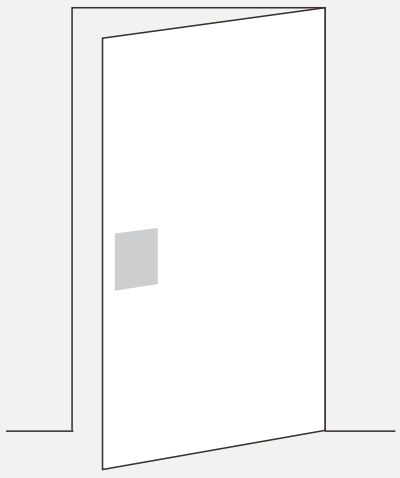
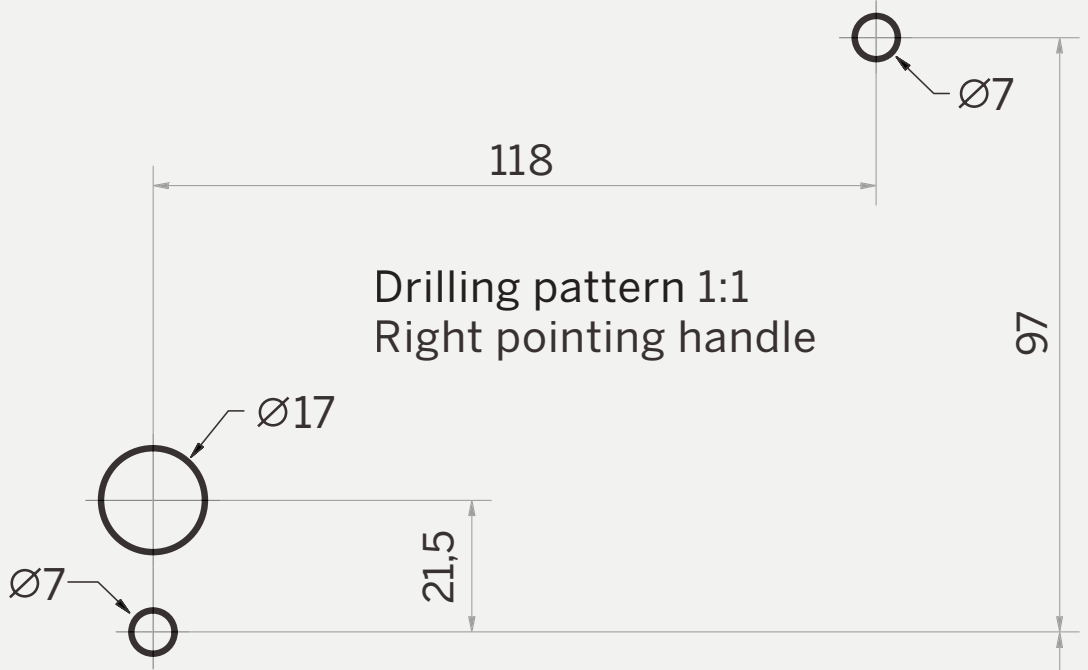

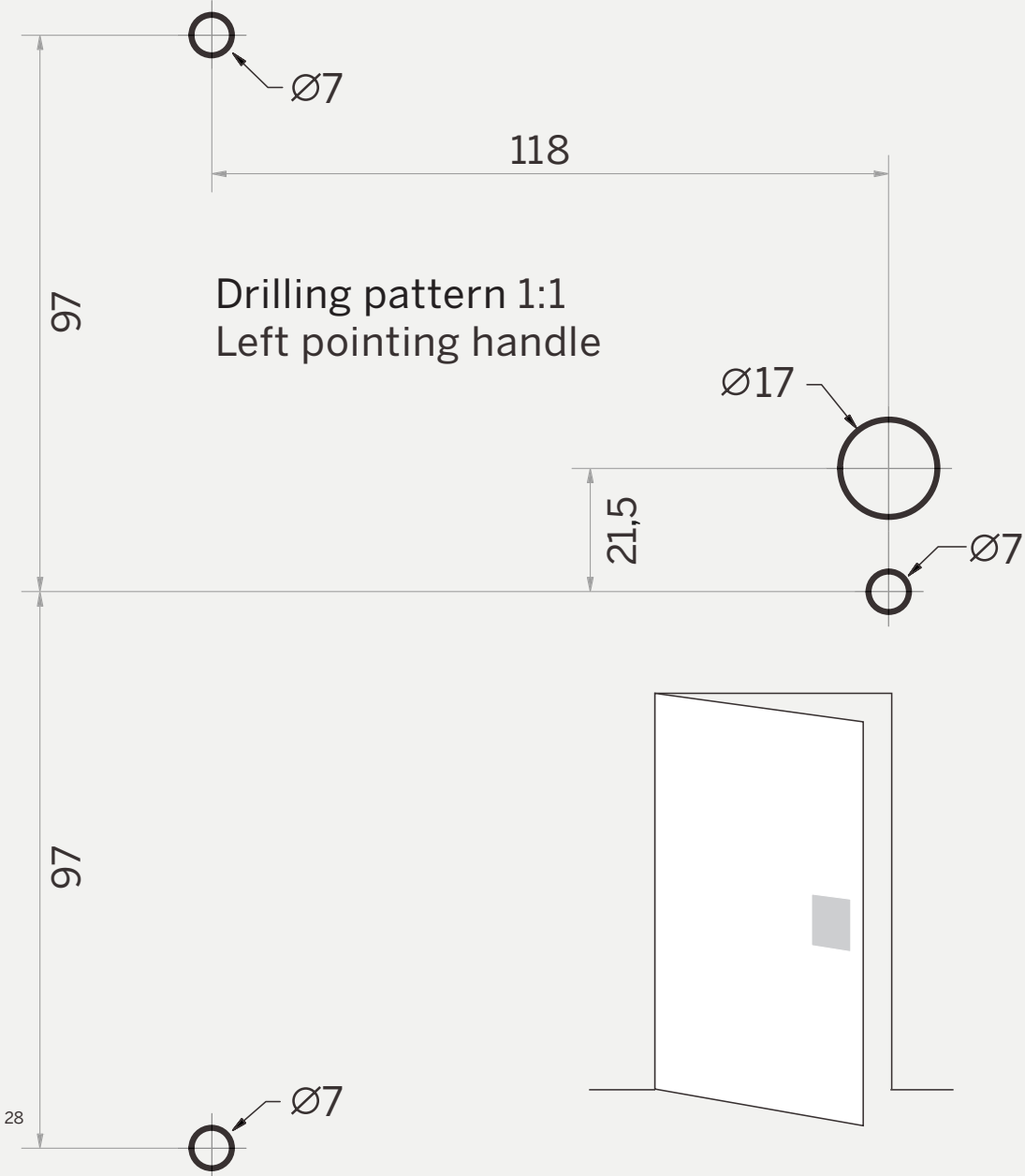

■ Drilling pattern pointing to the left
HEUSSER-Inset Locks

■ Determine the length of the handle pin

It is necessary to determine the correct length of the handle pin in order to install the HEUSSER-Inset Lock in compliance with the standards. To do this, please proceed as follows:

1. Determine the distance from the outside of the door to the centre of the lock (D).
2. Find your Inset Lock / Plate with the handle used in the table.
3. Determine your pin length (P) according to the specifications.

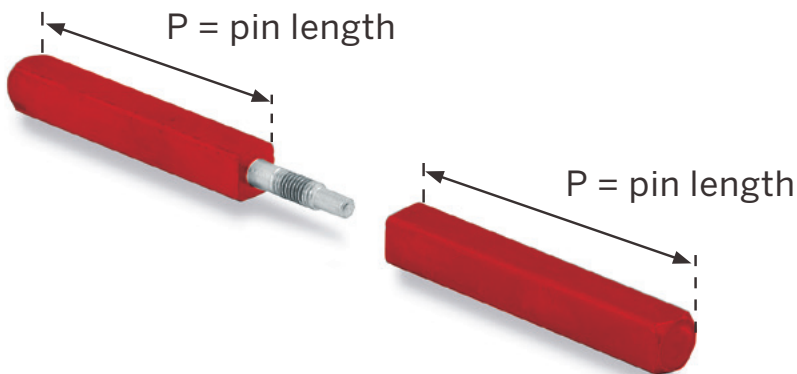

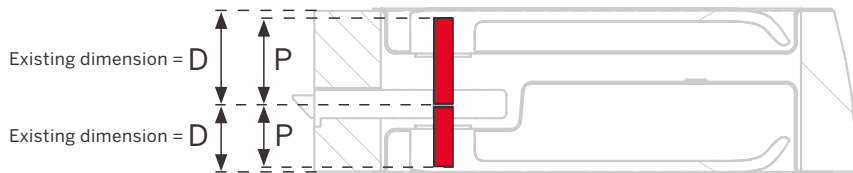

	Handle D1	Handle D2	Handle D3	Handle D4
Inset Lock S1.0	$P = D + 19$	$P = D + 34$	$P = D + 19$	$P = D + 34$
Inset Lock S3.13	$P = D + 4$	$P = D + 19$	-	-
Inset Lock S3.20	$P = D - 2$	$P = D + 13$	-	-
Inset Lock S6.13	$P = D + 4$	$P = D + 19$	-	-
Inset Lock S6.20	$P = D - 3$	$P = D + 12$	-	-
Inset Lock S6.42	$P = D - 23$	$P = D - 10$	-	-
Inset Lock S9.13	$P = D + 4$	$P = D + 19$	$P = D + 4$	$P = D + 19$
Inset Lock S9.20	$P = D - 3$	$P = D + 12$	$P = D - 3$	$P = D + 12$
Inset Lock S.9.42	$P = D - 3$	$P = D - 10$	$P = D - 3$	$P = D + 12$

P = Pin length to centre of lock

D = Distance from outside of the door to centre of lock

All dimensions are in millimetres

■ DIN EN 179 Usage

The handles and locks for emergency exit locks are a safety-relevant assembly that can save human lives. The standards provided for this purpose must therefore be strictly adhered to.

If you have any questions or are unsure about something, please contact your specialist dealer, door planner or architect.

■ DIN EN 179

Suitable HEUSSER-Inset Locks

Handle D2 with all
HEUSSER-Inset Locks



Handle D3 with
HEUSSER-Inset Lock S9.42



Handle D4 with all
HEUSSER-Inset Locks



■ Colouration HEUSSER-Inset Locks

Would you like the colour of your inset lock to match your door or interior design?

Then you can purchase HEUSSER-Inset Locks powder-coated or painted in your desired RAL or NCS colour.







■ Legend

Nomenclature HEUSSER-Inset Locks

Order code

SD.MT.DD.A BC AD

SD: Series Design (S1, S3, S6, S9)

MT: Tray depth (0, 13, 20, 42 [mm])

DD: Handle Design (D1, D2, D3, D4)

A: Cutout (0 = blind, 2 = round cylinder, 3 = profile cylinder)

BC: Distance (RZ = 74, 78, 94 oder PZ = 60, 72, 78, 88, 92)

AD: Direction of Handle (L for left-pointing, R for right-pointing)

Sample HEUSSER-Inset Lock:

S9.20.D3.0R

Sample HEUSSER-Inset Lock:

S1.0.D4.372L

HEUSSER-Inset Locks Series 9



S9.42.D3
Tray depth: 42 mm
Handle overlap: 0 mm



S9.20.D3
Tray depth: 20 mm
Handle overlap: 0 mm



S9.13.D3
Tray depth: 13 mm
Handle overlap: 7 mm





S9.42.D4
Tray depth: 42 mm
Handle overlap: 24,5 mm



S9.20.D4
Tray depth: 20 mm
Handle overlap: 24,5 mm



S9.13.D4
Tray depth: 13 mm
Handle overlap: 31,5 mm

 Flush-mounted handle
 Emergency doors suitable and tested according to DIN EN179

HEUSSER-Inset Locks Series 3



S3.20.D1
Tray depth: 20 mm
Handle overlap: 0 mm



S3.13.D1
Tray depth: 13 mm
Handle overlap: 7 mm



S3.20.D2
Tray depth: 20 mm
Handle overlap: 26 mm



S3.13.D2
Tray depth: 13 mm
Handle overlap: 33 mm

HEUSSER-Inset Locks Series 6



EN179

S6.42.D2

Tray depth: 42 mm
Handle overlap: 4 mm



EN179

S6.20.D2

Tray depth: 20 mm
Handle overlap: 26 mm



EN179

S6.13.D2

Tray depth: 13 mm
Handle overlap: 33 mm



S6.20.D1

Tray depth: 20 mm
Handle overlap: 0 mm



S6.13.D1

Tray depth: 13 mm
Handle overlap: 7 mm



Flush-mounted handle



Emergency doors suitable
and tested according to
DIN EN179

HEUSSER-Inset Locks Series 1



S1.0.D1

Handle overlap: 20 mm
S1.0.D1: with thread
SIG.0.D1: perforated



EN179

S1.0.D2

Handle overlap: 46 mm
S1.0.D2: with thread
SIG.0.D2: perforated



S1.0.D3

Handle overlap: 20 mm
S1.0.D1: with thread
SIG.0.D1: perforated



EN179

S1.0.D4

Handle overlap: 44.5 mm
S1.0.D1: with thread
SIG.0.D1: perforated



Schlossfabrik Heusser AG
Murgstrasse 11
CH - 4923 Wynau

www.heusser-schloss.ch
info@heusser-schloss.ch

01.2022